

WALL SECTION DETAIL

TYPICAL REQUIREMENTS

FLOATING SLAB FOUNDATION INSULATION
THE INSULATION MUST NOT BE LESS THAN R-5

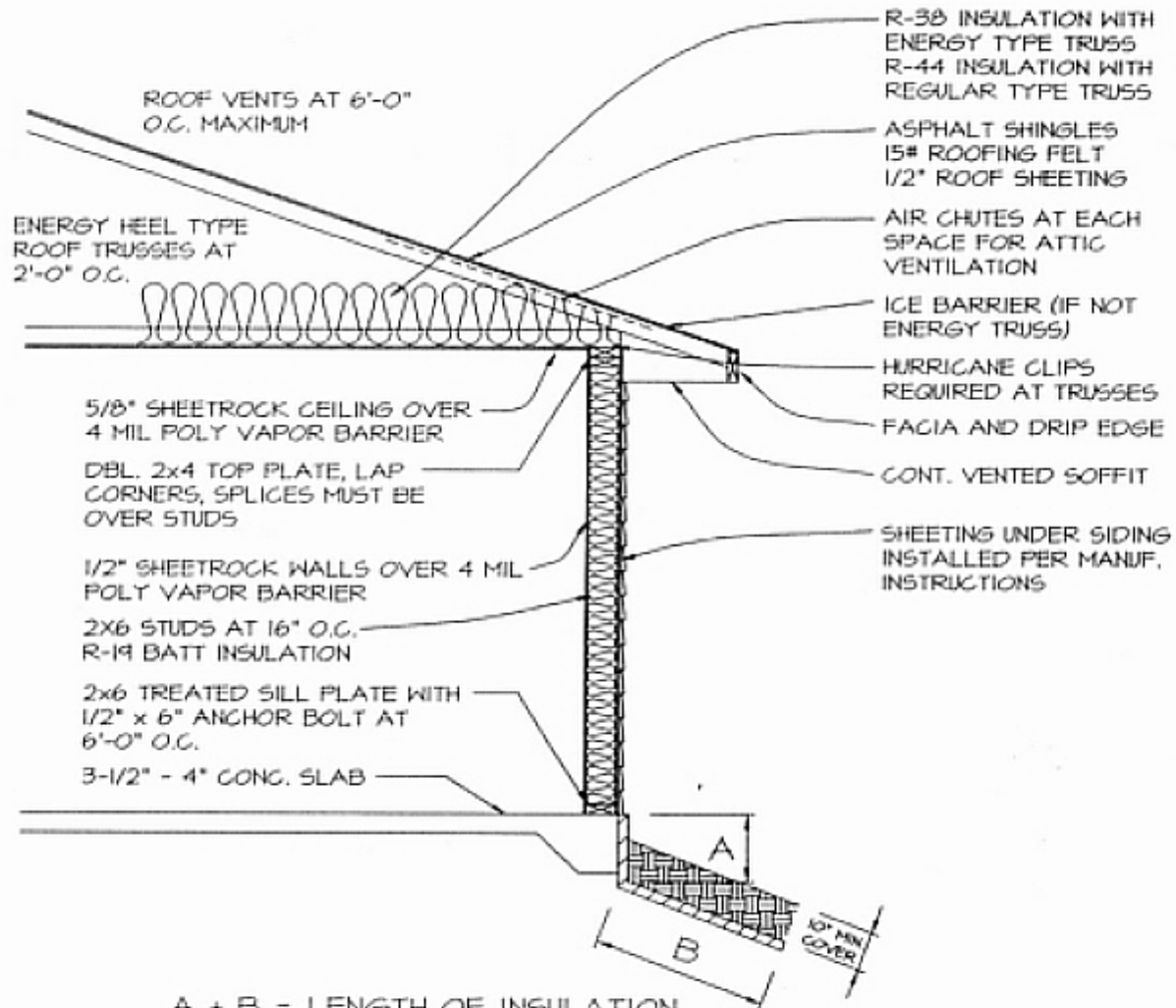

A + B = LENGTH OF INSULATION

THIS LENGTH IS EQUAL TO THE DIMENSION FROM THE TOP OF THE FOUNDATION TO THE DESIGN FROST DEPTH. FOR EXAMPLE, A FOUNDATION THAT IS 6" ABOVE GRADE IN AN AREA THAT REQUIRES A 42" FROST LINE, THE "A" = "B" DIMENSION IS 6" + 42" = 48"

MN RULES SECTION 7672.0600

EXHIBIT (7)